

2/2022

Celling Height 14' 7-3/8" – Height to beams 13'6"
Height to AC DUCTS - 11'6"

Exit door – can not be blocked

Mobile Storefront Studio

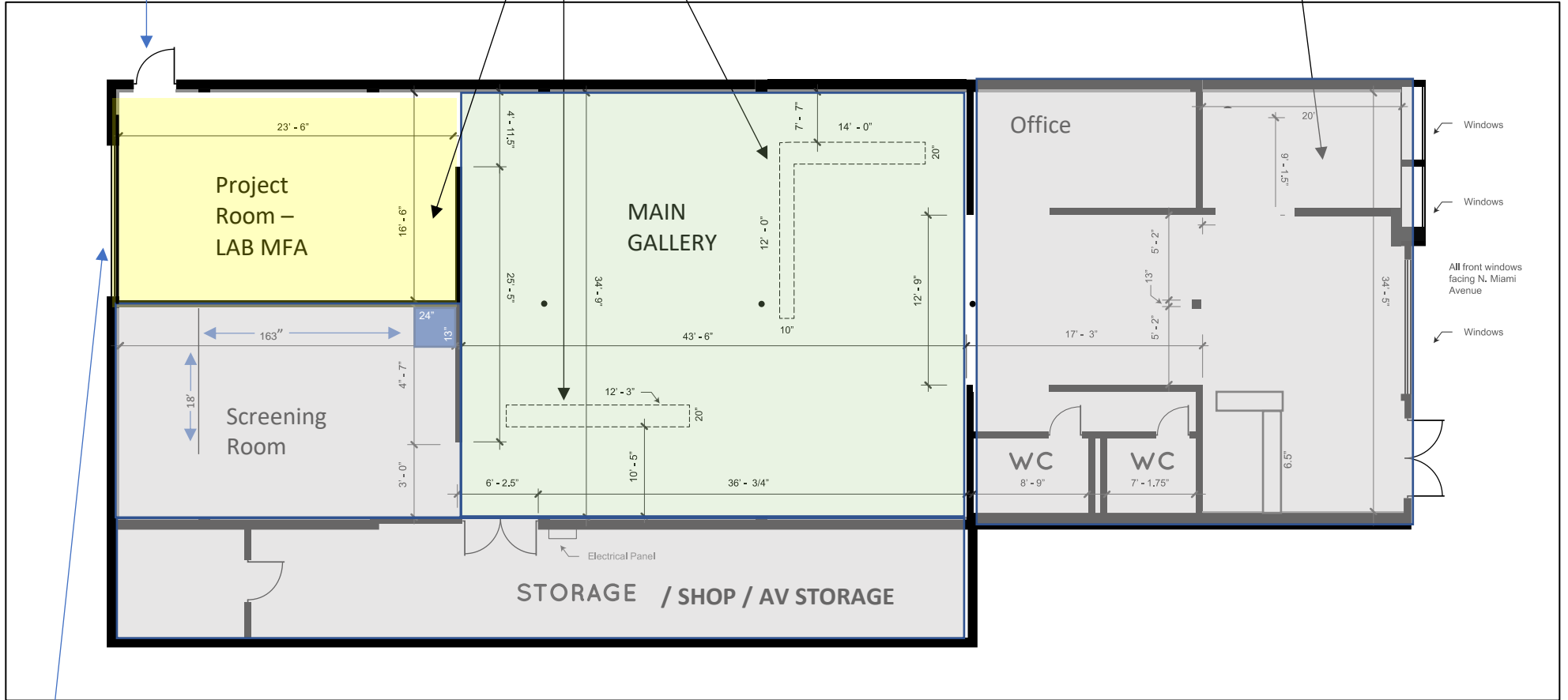

Note garage door is covered by drywall wall

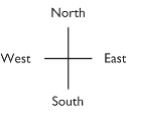

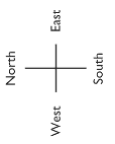

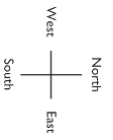



A landscape longed for: the garden as disturbance, 2021 (depicts exit door on north wall; yellow wall is covering the garage door)

